

# APPENDIX S – MACKENZIE PARK DEVELOPMENT PLAN

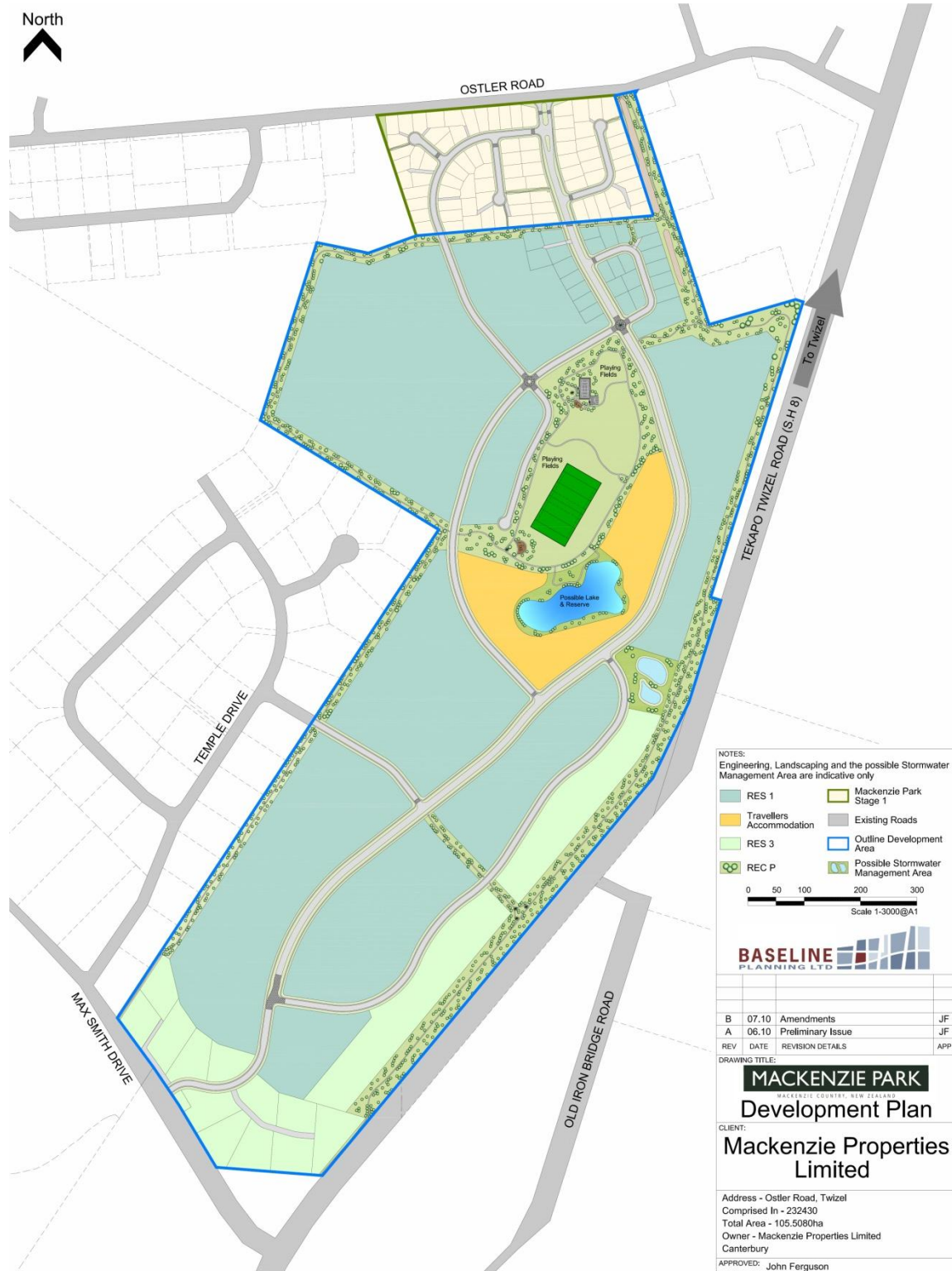

NOTES:  
Engineering, Landscaping and the possible Stormwater Management Area are indicative only

- RES 1
- Travellers Accommodation
- RES 3
- REC P
- Mackenzie Park Stage 1
- Existing Roads
- Outline Development Area
- Possible Stormwater Management Area



B	07.10	Amendments	JF
A	06.10	Preliminary Issue	JF
REV	DATE	REVISION DETAILS	APP

DRAWING TITLE:

## MACKENZIE PARK Development Plan

CLIENT:  
**Mackenzie Properties Limited**

Address - Ostler Road, Twizel  
Comprised In - 232430  
Total Area - 105.5080ha  
Owner - Mackenzie Properties Limited  
Canterbury

APPROVED: John Ferguson

DRAWN BY: MKL Draughting

DATE: 06.10	DESIGN: JF
JOB No: 837002	CHECKED: JF
SCALE: 1-3000@A1	DRAWING No: 1B



2nd Floor, Bates Building, 136 Worcester Street, PO Box 13-539, Christchurch 8141  
p: 03 963 8706 - f: 03 963 8726 - e: info@baselineplanning.co.nz  
Baseline Planning Ltd is Part of the Urbis Group of Companies